

## **OFFICIAL PREMIUM LIST**

**MANITOBA GAZEHOUND ASSOCIATION**

**2 LICENSED CHASE ABILITY TESTS**

**Saturday - JUNE 30TH & Sunday JULY 1st, 2018**

**MORRISON SPORTS PARK**

**OAKVILLE, MANITOBA**

**JUDGES:**

Christine Gillies - 385 Amherst St, Winnipeg, MB R3J 1Z1 (June 30)

Jocelyne M. Gagne, 128 Pearson Rd, Welland, ON L3B 5N4 (July 1)

**LURE OPERATOR:** Karl Schnablegger

Send Entries to: **EVENT SECRETARY**  
Candace Cook  
Box 12, Group 553, RR5  
Winnipeg, MB R2C 2Z2  
204-222-4789  
shakula@mts.net

**PRE-ENTRIES CLOSE:** **Friday, June 22, 2018**

**FIELD ENTRIES CLOSE:** 30 minutes prior to Roll Call  
Entries will not be accepted by phone

**Roll Call:** Saturday **JUNE 30/18 - 5:00 pm**  
Sunday **JULY 1/18 - following Lure Coursing Trial - **Approx. 6:00 pm****

These events are held under the rules of The Canadian Kennel Club.

## CKC OFFICIALS

CKC Executive Director: Lance Novak  
Head Office Address: 200 Ronson Drive, Suite 400, Etobicoke, ON M9W 5Z9  
Manitoba CKC Lure Coursing Rep: Christine Gillies  
Manitoba CKC Board Member: Larry Kereluke

It shall be the duty and obligation of the trial-giving club to see that a judge, club official, volunteer or any participant at an event held under these rules is not subject to indignities of any kind. The Field Trial Committee Chair shall promptly report to the CKC any infringement of this regulation, and the Discipline Committee shall have the authority to take such action as it deems fit on receipt of a report indicating that this has occurred.

## OFFICERS OF THE MGA

Event Superintendent: Tannis Tindall  
President: Tannis Tindall  
Vice President: Christine Gillies  
Secretary: Candace Cook  
Treasurer: Candace Cook  
Event Secretary: Candace Cook

## ENTRY FEES

Pre-entry: (up to June 1, 2018)  
\$20.00 1st dog, \$18.00 2nd and subsequent dog

Post-entry: \$25.00 per dog

## OTHER FEES

\$10.00 CKC listing fee for all non-CKC registered dogs (includes 5% GST)  
\$25.00 fee for NSF cheques

Make cheques payable to: MANITOBA GAZEHOUD ASSOCIATION

Any overpayment of entry fees is considered a trophy donation.

NO CREDIT CARDS or POST DATED CHEQUES will be accepted.

**THERE IS A WAIVER FORM IN THIS PREMIUM LIST THAT MUST BE SIGNED AND WHICH MUST ACCOMPANY YOUR ENTRIES OTHERWISE THEY WILL NOT BE ACCEPTED.**

**ELIGIBLE BREEDS:** The Chase Ability Program participation is open to all purebred and mixed-breed dogs at least 12 months of age that are individually registered with the CKC; or have an Event Registration Number (ERN); or have a Performance Event Number (PEN); or eligible for registration with the CKC; or have a Miscellaneous Certificate Number (MCN) if it belongs to a CKC listed breed; or have a Canine Companion Number (CCN) if it's a mixed breed.

Dogs with Breed disqualifications are eligible to enter.

Females in season may not enter.

A dog may enter only once per test.

Running order determined by order in which entries are received,

Dogs run in singles (by themselves)

## RIBBONS:

Gold Qualifying ribbons will be awarded to dogs passing their test.

### 300 YARD COURSE

This distance is for dogs shorter than 12 inches at the withers or brachycephalic (flat faced) dogs. The CKC has determined the following breeds are brachycephalic.

- Affenpinscher
- Boston Terrier
- Boxer
- Brussels Griffon
- Bulldog (all breeds)
- Chihuahua - Apple-Headed
- Chow Chow
- English Toy Spaniel
- Japanese Chin
- Lhasa Apso
- Pekingese
- Pug
- Shih Tzu
- Shar-Pei
- Tibetan Spaniel

### 600 YARD COURSE

This distance is used for all dogs that do not run the 300 yard course.

IF THERE IS A QUESTION AS TO WHICH COURSE A DOG SHALL RUN THE JUDGE SHALL DECIDE.

### ATTENTION EXHIBITORS:

- There will be a \$10.00 fine for dogs loose on the field or in the area of the event other than the dog running the course.
- Dogs will be run once per test.
- Lame dogs or bitches in season will be excused and their entry refunded, provided notice is given prior to or during roll call.
- Dogs not present at roll call shall be scratched with no refunds. No exceptions.
- Muzzles and catch collars may be used at the handler's discretion. **NO FLEXI LEADS, SHOCK COLLARS OR PRONG COLLARS ALLOWED.**
- Catch collars must be free of any item that could become entangled in the line (e.g.: tags)
- A veterinary clinic is located in the town of Portage la Prairie.
- There is plenty of parking. Bathrooms available.
- Lots of room for crates but bring shade for your dogs and plenty of water.
- People are expected to clean up after their dogs. There will be a \$10.00 fine for caught NOT cleaning up after their dogs.

### DIRECTIONS TO THE FIELD

Traveling West from Winnipeg: Head west on Trans Canada HWY #1 towards Portage la Prairie for approximately 55 km (from West Perimeter).

Turn left onto HWY 13 (south). There are signs for Oakville/Carman.

After 2.5 km turn right (west) onto HWY 331. There is a sign for Newton.

Park entrance is on the left hand side (south) very near this intersection.

Traveling East from Portage la Prairie: Head east on Trans Canada Hwy #1 towards Winnipeg. It is approximately 32 km from the CanadInn to HWY 13.

Turn right onto HWY 13 (south). There are signs for Oakville/Carman.

After 2.5 km turn right (west) onto HWY 331. There is a sign for Newton.

Park entrance is on the left hand side (south) very near this intersection.

\*\*\* SIGNED WAIVER MUST ACCOMPANY ENTRY FORM OR ENTRY WILL BE DENIED \*\*\*

**MANITOBA GAZEHOUD ASSOCIATION WAIVER**

**RELEASE OF LIABILITY, WAIVER OF CLAIMS, ASSUMPTION OF RISK AND INDEMNITY AGREEMENT**

**PLEASE READ THIS DOCUMENT CAREFULLY**

**BY SIGNING THIS DOCUMENT YOU WILL WAIVE CERTAIN LEGAL RIGHTS, INCLUDING THE RIGHT TO SUE OR CLAIM COMPENSATION FOLLOWING AN ACCIDENT.**

I \_\_\_\_\_ (PRINT NAME) certify that I am the actual owner of this/these dog(s) \_\_\_\_\_ (PRINT NAMES OF DOG(S)) or that I am the duly authorized agent/handler of the actual owner whose name I have entered above.

In consideration of acceptance of the entry and the opportunity to have the dog judged and to win ribbons or prizes at the **CHASE ABILITY** events to be held on **June 30 & July 1, 2018**, I agree:

1. To hold the Manitoba Gazehound Association including their members, directors, officers and employees (collective defined as the "MGA"), as well as the owner and lessor of the real property on which the event is held, harmless from any claim for loss or injury which may be alleged to have been caused directly or indirectly to any person or thing by the act of myself or my dog(s) while in or about the event premises or grounds near the entrance thereto and I assume all responsibility and liability for any such claim;
2. To hold the MGA harmless from any claim for loss of this dog by disappearance, theft, death or otherwise and from any claim for damage or injury, even if such loss or damage/injury was caused or alleged to be caused by negligence of the MGA or by the negligence of any other person for any other cause(s).
3. Assume the sole responsibility for and agree to indemnify, defend and save the MGA harmless from any and all loss and expense, including legal fees, by reason of the liability imposed by law upon the MGA for damage because of bodily injuries, including death at any time resulting therefrom, sustained by any person(s), including myself, or on account of damage to property, arising out of or in consequence of my participation in the event, however such injuries, death or property damage may be caused and whether or not the same may have been caused or may alleged to have been caused by the negligence of the MGA or any other person(s);
4. That any cause of action, controversy or claim arising out of or related to the attendance and/or participation at this event between the MGA and myself or as to the construction, interpretation and effect of this waiver shall be settled by arbitration in the province of Manitoba, Canada and
5. That the MGA has the right to refuse this entry for cause, which the MGA will deem sufficient.

\_\_\_\_\_  
PRINT NAME OF HANDLER/AGENT

\_\_\_\_\_  
DATE

-----  
SIGNATURE(S) OF OWNER/HANDLER/AGENT



Official Entry Form  
CHASE ABILITY TEST

JUNE 30 & July 1, 2018

MANITOBA GAZEHOUND ASSOCIATION

Mail entries to: Manitoba Gazehound Association  
c/o Candace Cook, Box 12 Group 553 RR5 Winnipeg, MB, R2C 2Z2

Saturday, June 30, 2018 Test #1 \_\_\_\_\_

Sunday, July 1, 2018 Test #1 \_\_\_\_\_

Entry \$ \_\_\_\_\_ Listing \$ \_\_\_\_\_ Total \$ \_\_\_\_\_

Breed: \_\_\_\_\_ Dog's Height at Withers \_\_\_\_\_

Call Name: \_\_\_\_\_ Brachycephalic Breed? \_\_\_\_\_

Registered Name of Dog: \_\_\_\_\_

Date of Birth: \_\_\_\_\_ Place of Birth: Canada \_\_\_\_\_ Elsewhere \_\_\_\_\_

CKC Reg. No. \_\_\_\_\_ Listed: Yes \_\_\_\_\_ No \_\_\_\_\_

CKC ERN No. \_\_\_\_\_ CKC PEN No. \_\_\_\_\_

CKC MCN No. \_\_\_\_\_ CKC CCN No. \_\_\_\_\_

Breeder(s) \_\_\_\_\_

Sire: \_\_\_\_\_

Dam: \_\_\_\_\_

Registered Owner(s): \_\_\_\_\_

Owner's Address: \_\_\_\_\_

City \_\_\_\_\_ Province \_\_\_\_\_ Postal Code \_\_\_\_\_

I certify that I am the registered owner(s) of the dog or that I am the authorized agent of the owner(s) whose name(s) I have entered above and accept full responsibility for all statements made in this entry. In consideration of this entry, I (we) agree to be bound by the rules and regulations of the Canadian Kennel Club and by any additional rules and regulations appearing in the Premium List.

-----  
Signature of Owner (Agent)

-----  
Phone Number

-----  
Email address

PLEASE PRINT CLEARLY.

JUNE 30/18

Chase Ability

Club House

620 yds

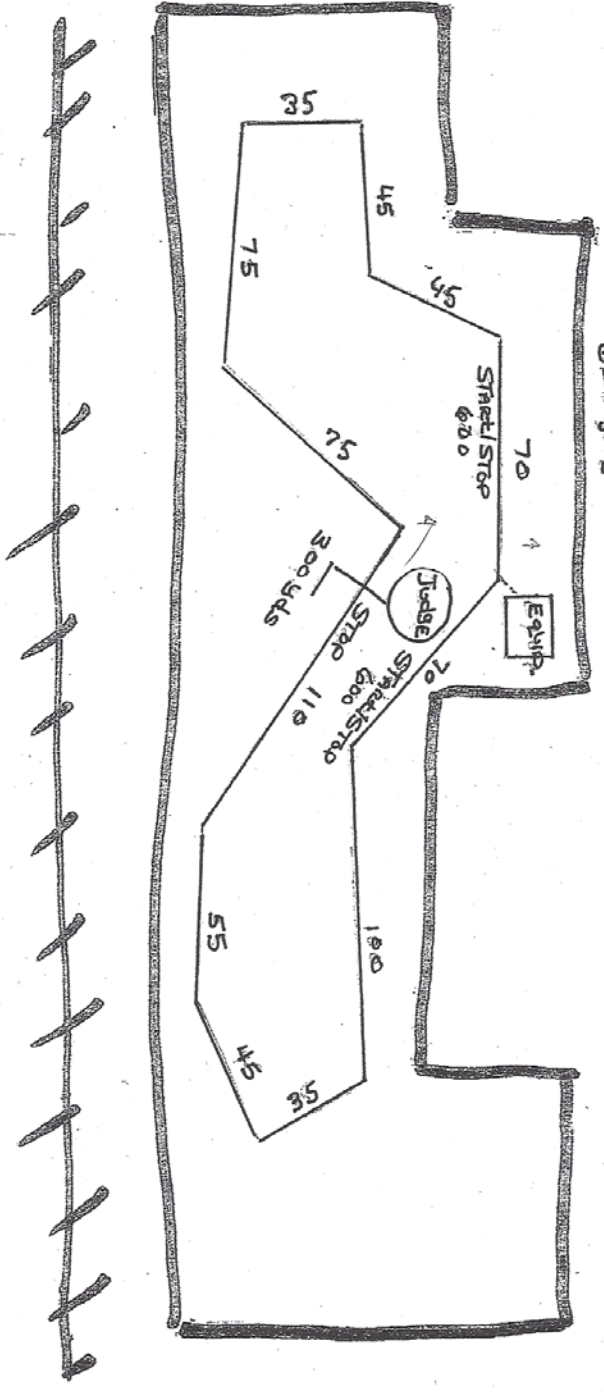

July 01 / 18

Lure Coursing

Chase Ability

Club House

Lure Coursing 735 yds

Chase Ability 640 yds

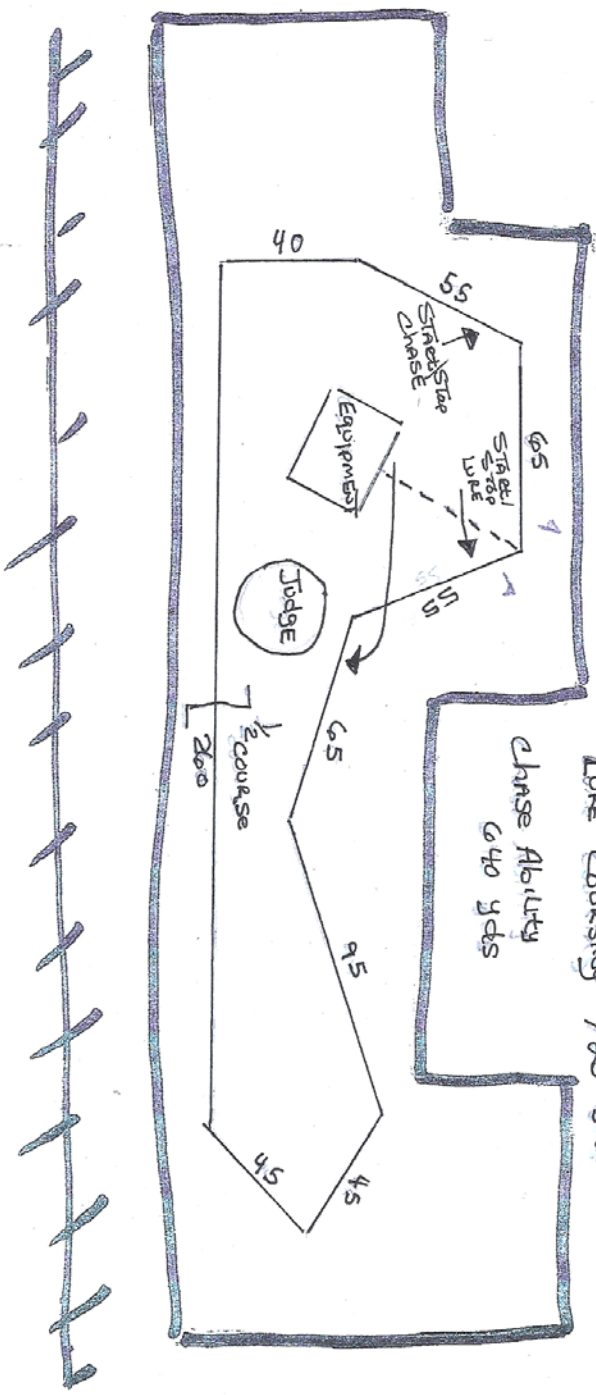

725