

BYTOWN DOG OBEDIENCE CLUB

Judging Schedule - Saturday, Sunday May 7 & 8, 2011

Fred Barrett Arena, 3280 Leitrim Rd, Ottawa, Ontario K1G 3N2

HIT OF HITS- Saturday May 7, 2011 - In the evening following all Trials

MOVING UP – OBEDIENCE

CKC RULES AND REGULATIONS (EFFECTIVE JANUARY 01, 2008)

6.8.1 A dog that is registered in the records of the CKC or has a PEN, and ERN, or a MCN and has fulfilled the requirements for a title in accordance with these rules but at the time of the closing of entries for the trial has not received confirmation of the title may be moved to the next level of competition providing the request is submitted to the trial secretary on the appropriate move-up form by the owner or handler a minimum of one hour before the opening of the first trial on that day, schedule permitting.

6.8.2 When one or more trials are held on the same day in the same venue, the request for moving the dog up must be made a minimum of one hour prior to the scheduled start of the trial for which the dog is being moved up to, schedule permitting. The Trial Secretary shall amend the judge's book and the marked catalogue, which is to be sent to the CKC with the requests attached to the appropriate entry forms.

Bitches, when in season, are not permitted to compete in the Trial, however, entry fees will be refunded, providing a veterinarian's certificate stating that the bitch was in season within the 10 day period preceding the trial, is submitted to the Trial Secretary, on or before the date of the trial.

DIRECTIONS TO THE SHOW SITE

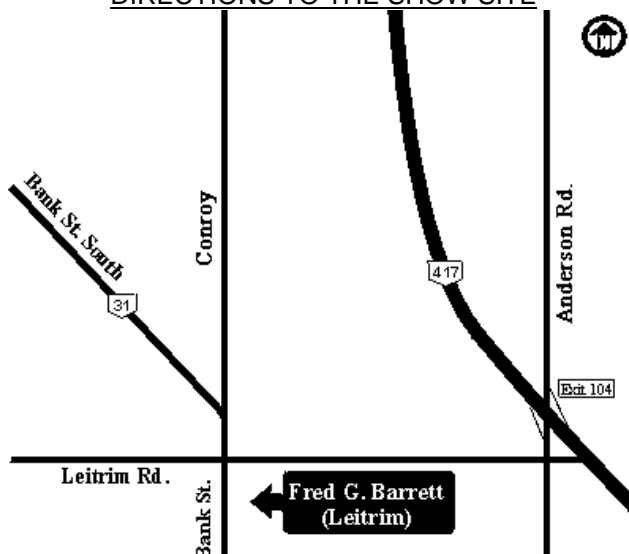

DRIVING INSTRUCTIONS:

From Hwy-401: Hwy-401 to Hwy-31 North. Proceed north on Hwy-31 approx. 40 km to Leitrim Road. Turn right on Leitrim Road. Watch for arena on the right, approx. 50 yards past the intersection of Hwy-31 (Bank St.) and Leitrim Road.

From Ottawa: Hwy-417 east approx. 7 km to Walkley Rd. West (exit 110). Proceed west on Walkley Rd. approx. 1 km to Russell Road. Turn left on Russell Rd. and proceed south approx. 0.3 km to Hawthorne Avenue. Continue straight onto Hawthorne Ave. and proceed south approx. 4 km to Leitrim Road. Turn right on Leitrim Rd. and proceed west approx. 1.75 km to arena on the left (just before Bank St./Hwy-31).

From the East (Hwy-417): Hwy-40/Hwy-417 west approx. 170 km to Anderson Rd. (exit 104). Turn left on Anderson Rd. and proceed south approx. 1.25 km to Leitrim Road. Turn right on Leitrim Rd. and proceed west approx. 6 km (follow Ramsayville Rd. south approx. 100 meters to pick up Leitrim Rd. again) to arena on the left (just before Bank St./Hwy-31).

NO UN-ENTERED DOGS ALLOWED WITHIN THE SHOW PRECINCTS

Bytown Dog Obedience Club	
Trial # 181 Judge – Donald Wallace Ring # 1 Saturday May 7, 2011	9:00 am - (4) Pre Novice - 296, 298, 299, 301
	(3) Novice "A" - 304, 306, 307
	(3) Novice "B" - 310, 314, 315
	(6) Open "A" - 316, 320, 321, 323, 324, 326
	(7) Open "B" - 333, 335, 346, 347, 349, 351, 352
	LUNCH BREAK
	12:45 pm - (8) Utility - 356, 353, 351, 349, 347, 344, 335, 333
Trial # 182 Judge – James Ham Ring # 2 Saturday May 7, 2011	9:00 am - (3) Utility - 333, 344, 356
	(6) Open "B" - 328, 333, 336, 346, 348, 352
	(2) Novice "A" - 305, 307
	(4) Novice "B" - 308, 310, 314, 315
	(4) Pre Novice - 297, 298, 300, 301
	LUNCH BREAK
	12:45 pm
	(8) Open "A" - 318, 319, 320, 322, 323, 324, 325, 326
(5) Obedience Brace - 11:45 pm – Ring # 2 Judge – Frances Holmes # 336/ # 340 - # 347/ # 355 - # 360/ # 363 - # 364/ # 366 - # 369/ # 370	
Trial # 183 Judge – Bruce Gibbons Ring # 3 Saturday May 7, 2011	9:00 am - (6) Open "A" - 316, 318, 319, 321, 324, 327
	(5) Pre Novice – 297, 298, 299, 300, 301
	(5) Utility - 333, 349, 353, 355, 356
	(1) Novice "A" - 303
	(3) Novice "B" - 308, 310, 315
	LUNCH BREAK
	12:45 pm - (7) Open "B" - 333, 334, 340, 348, 349, 350, 352
Trial # 184 Judge – Donald Wallace Ring # 1 Sunday May 8, 2011	10:00 am - (7) Utility - 329, 338, 340, 343, 344, 353, 354
	(9) Open "B" - 328, 329, 331, 338, 340, 342, 343, 344, 346
	LUNCH BREAK
	12:45 pm - (2) Open "A" - 326, 327
	(1) Pre Novice - 299
	(3) Novice "A" – 304, 306, 307
	(3) Novice "B" - 309, 313, 314
Trial # 185 Judge – James Ham Ring # 2 Sunday May 8, 2011	10:00 am - (1) Pre Novice - 296
	(2) Novice "A" – 302, 307
	(4) Novice "B" - 308, 311, 312, 314
	(2) Open "A" - 316, 326
	(4) Utility - 330, 335, 340, 343
	LUNCH BREAK
	12:30 pm – (6) Open "B" - 330, 331, 335, 340, 343, 346
Trial # 186 Judge – Bruce Gibbons Ring # 3 Sunday May 8, 2011	9:00 am –
	(11) Open "B" - 329, 331, 332, 334, 335, 339, 342, 344, 345, 350, 351
	(1) Pre Novice - 299
	(1) Novice "A" - 302
	(3) Novice "B" - 308, 309, 313
	(4) Open "A" - 316, 317, 323, 325
LUNCH BREAK	
	12:30 pm - (9) Utility - 354, 353, 351, 345, 344, 339, 335, 332, 329

1960



2011