

Official Premium List



ALBERTA LURE COURSING ASSOCIATION

Announces

ONE CKC LURE FIELD TRIALS OCTOBER 8, 2016
(Outdoors)

These Events Held Under the Rules of the Canadian Kennel Club

To Be Held At:

Bremner House

53452 Rge Rd 225, Sherwood Park, AB T8A 4V3

Co-Ordinates: Lat 53 deg, 36', 30.0" N

Long -113 deg, 13', 29.0" W

Mail ALL Entries To:

Miriam Woestenburg,

12927-78 St. Edmonton, AB.

T5C 1G6

(780) 456-2866

E-mail: minidragon@shaw.ca

Secure on-line entry service now available at

www.dogshow.ca (VISA, Mastercard, American Express & Interac)



Field Trial Pre-Entry Closes: Wednesday October 5, 2016

Post Entry Closes:	Saturday	8.30 a.m.	Coursing Official Classes Singles, Puppy, Veteran
Roll Call:	Saturday	9.00 a.m.	Coursing Official Classes Singles, Puppy, Veteran

Rolling Inspection from arrival to Roll Call

WAVIERS CAN BE SIGNED BEFORE ROLL-CALL

LURE TRIAL OFFICIAL CLASSES OFFERED

Open Stake - for all eligible hounds one year of age or older, including Field Champions. If there are multiple breeds with entries of three or less, upon agreement of all owners, they will be combined in a **Mixed Stake**.

LURE TRIAL UNOFFICIAL CLASSES OFFERED

Best In Field – to include all Best of Breed or Mixed Stake winners

Singles – will be run once, after Preliminary run

Puppy – (6-9, 9-12, 12-18 months) - after Preliminary Singles run (before potluck)

Veteran – (eligible for dogs 7 years and older) - after Preliminary Singles run (before potluck)

Kennel Stake

Breeder Stake

Club Stake

ENTRY FEES:

LURE FIELD TRIAL

Pre-entry, first hound (closes Oct 5th)

\$22.00 includes CKC recording fees

Pre-entry, each additional hound same owner/co-owner

\$20.00 includes CKC recording fees

Post entry (after Oct 5th)

\$25.00 includes CKC recording fees

Listing Fee for each entry without a CKC Number PER EVENT

\$8.95

SINGLES (will run once)

\$10.00

PUPPY, VETERAN, KENNEL, BREEDER, CLUB

\$5.00



TOLL FREE FAX: 1-877-99-ENTRY (36879)



A service charge of 10% will be assessed. This includes entries sent online, by fax or post using a credit card or Interac for payment.

COURSING JUDGES:

Barbara (Bobbi) Westman
Ed Molloy
Linda Smith
Pat Ingram

10818 79 Ave. Edmonton AB T6E 1S5 - Ibizan
169-52061 Rge Rd 215 Sherwood Park AB T8E 1S5 – Ibizan & Whippet
11228 100 Ave Edmonton AB T5K 0H9 – All breeds except Ibizan and Whippet
Box 20 Site 27 RR 7 Calgary AB T2P 2G7 – All breeds except Ibizan

JUDGING ASSIGNMENTS:

	Saturday Oct 8
Afghan	Linda Smith, Pat Ingram
Basenji	Linda Smith, Pat Ingram
Borzoi	Linda Smith, Pat Ingram
Deerhound	Linda Smith, Pat Ingram
Greyhound	Linda Smith, Pat Ingram
Ibizan Hound	Ed Molloy, Barbara (Bobbi) Westman
Irish Wolfhound	Linda Smith, Pat Ingram
Italian Greyhound	Linda Smith, Pat Ingram
Pharaoh Hound	Linda Smith, Pat Ingram
Saluki	Linda Smith, Pat Ingram
Whippet	Ed Molloy, Pat Ingram
Mixed Stakes	Linda Smith, Pat Ingram
Singles	TBA

ROLL CALL TIMES AND RUNNING ORDERS

We are offering a Rolling inspection between the time you arrive and Roll Call.

Official Classes, Singles, Puppy Stake & Veteran Stake Post Entry closes at 8.30 a.m.

Official Classes, Singles, Puppy Stake & Veteran Stake Roll Call 9:00 a.m.

Breed running order will be posted at Roll Call.

Puppy Stakes and Veterans will be run after the Singles Preliminary run.

Best in Field - Open to all Breed and Mixed Stake winners.

CERTIFICATION RUNS

Certification runs **by appointment only** Friday evening. Cost is \$15.00. Please make your own arrangements for a suitable dog to run yours with. Call Ed at 780 922-5218 to make the arrangements. CKC requirements for eligibility under **FAQ's**.

PRIZES & AWARDS

OPEN:

Best Of Breed, First in Mixed Stake and Best in Field: Rosette & prize
Second to Next Best Qualifier: Rosette

Qualifying Score: Ribbon will be offered for each **qualifying score** earned by a hound which has not previously earned the Novice Courser Title. Please let the Field Trial Secretary know if your hound qualifies.

BEST OF BREED

GREYHOUND Donated by Monique Cormier

SINGLES:

Highest scoring Singles run: First Place Rosette - 2nd to NBQ: Ribbon

BEST PUPPY:

Highest score for a **Puppy in Field:** Rosette & prize
First to Next Best Qualifier in each age class: Ribbon

BEST VETERAN:

Highest score for a **Veteran in Field:** Rosette **2nd** to **NBQ:** Ribbon

NOVICE:

Highest Weekend Aggregate Score for a Hound competing in its First Trial: Rosette
Total of qualifying scores for the weekend, adjusted for judges' averages.

KENNEL STAKE:

Rosette (scores adjusted for judges' averages)

BREEDER STAKE:

Rosette (scores adjusted for judges' averages)

CLUB STAKE:

Rosette (scores adjusted for judges' averages)

2016 AGGREGATE AWARD:

A large Rosette and Gift Basket will be awarded for High Point Aggregate. To be awarded to the hound qualifying in **all** five ALCA trials for 2016. Award will be determined by total qualifying scores adjusted for judges' average. In the event of a tie, a coin toss will determine choice of ribbon or prize. Donated by Miriam & Piet Woestenburg.

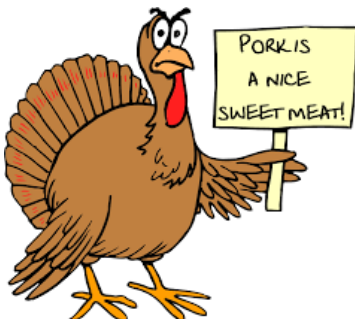

Happy Thanksgiving



Welcome to the 4th annual Turkey
Trot Lure Coursing Lunch!

Adults \$10 x _____

Kids \$8 x _____

Total \$ _____

Includes all the fixings
and desserts !!!



FIELD TRIAL COMMITTEE AND OFFICIALS		ALBERTA LURE COURSING ASSOCIATION 2016 EXECUTIVE	
Field Trial Chair	Ivy Molloy	President	Bobbi Westman
Field Trial Committee:	Ivy Molloy Elizabeth van Husen Miriam Woestenburg Cindy Kremer	Vice President	Cherie Hunchak
Field Clerk	Karen Steinbring Elizabeth van Husen	Secretary	Miriam Woestenburg
Field Trial Secretary	Miriam Woestenburg	Treasurer	Ivy Molloy
Lure Operators	Cherie Hunchak		
Hunt Master	Brendan Molloy Piet Woestenburg		
Paddock Master	Cindy Kremer		
COMPLAINTS COMMITTEE: Ivy Molloy, Miriam Woestenburg, Elizabeth van Husen, Cindy Kremer			

ATTENTION:

It shall be the duty and obligation of the trial-giving club to see that a judge, club official, volunteers or any participant at the CKC any infringement of this regulation, and the Discipline Committee shall have the authority to take such action as it deems fit on the receipt of a report indicating that this has occurred.

CANADIAN KENNEL CLUB OFFICIALS:

THE CANADIAN KENNEL CLUB EXECUTIVE DIRECTOR

Mr. Lance Novak, 200 Ronson Drive, Suite 400, Etobicoke, ON, M9W 5Z9 (416) 675-5511

THE CANADIAN KENNEL CLUB DIRECTOR FOR ALBERTA

Sharon Derrick, 60 Riverview Cl SE, Calgary, AB, T2C 4C4, Tel: (403) 236-7280, sderrick@shaw.ca

ALBERTA LURE COURSING REPRESENTATIVE

Ms Pat Ingram, Box 20, Site 7, RR #7, Calgary, AB, T2P 2G9

OFFICIAL VETERINARIAN:

Uncas Veterinarian Clinic is within reasonable access of the trial grounds.

DIRECTIONS TO THE FIELD:

From South: Hwy 21 North to Township Road 534 (First road after Hwy 16 overpass)

Turn right (east) onto Twp Rd 534 and proceed to Range Road 225 (First cross road)

Turn left (north) onto Rge Rd 225. Field is 1 km north on left side of road. Entrance has SVTA in big letters over the gate

From West: Hwy 16 east to Range Road 225 (First road after Hwy 21, approx 2 km)

Turn left (north) on Rge Rd 225

Field is 4 km north of Hwy 16 on left side of road. Entrance has SVTA in big letters over the gate.

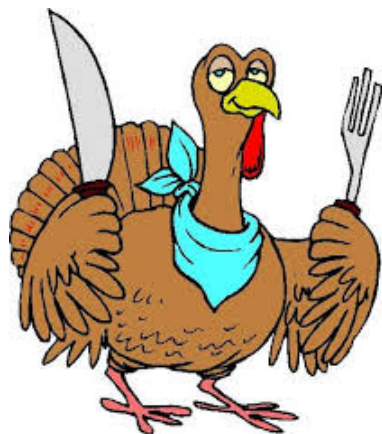

EQUIPMENT AND FIELD CONDITIONS:

The field is a mown hay field, flat on the west side, sloping towards the road.

An electric drag will be used for the Regular Classes and Singles.

A continuous loop may be used for the Puppy and Veteran stakes.

CONDITIONS AND INFORMATION:

- Rolling inspection – check in for inspection as you arrive, with your dog(s). Inspection ends ½ hour after entries close each day (roll call). It is your responsibility to take your dog for inspection prior to roll call.
- All hounds will be run in trios or braces, twice, unless excused, dismissed or disqualified.
- Hounds not present at roll call will be scratched, and their entry fee will NOT be refunded. No exceptions will be made.
- All handlers MUST use a slip lead when releasing their hounds.
- Hounds may wear muzzles and/or catch collars at the owner/agent's discretion.
- **Singles:** Is your dog DQ'd, declared ineligible or not ready for running in competition? This is the place to be! Dogs will be run individually and scored. A random draw will determine the order of running of dogs in this stake. No points are awarded and all ties will be settled by a coin toss. Your dog will be only given TWO opportunities to chase the lure each time it comes to the line. Handlers will not be able to run/walk the course with their hounds. Entry may be limited to 5 dogs.
- Bitches in season and lame hounds will be excused and will have their entry fee returned if notice is given to the secretary **prior** to roll call. A Veterinarian certificate may be required.
- The Chair may excuse any hound from competition for any reason deemed justifiable.
- A \$10.00 fine, payable to ALCA, will be levied for any hound loose on the field at any time between Roll Call and the completion of Best in Field or Regular classes.
- There is limited shade and no water available, so come PREPARED.
- There will be a concession with home cooking and baking available on the field.
- There will be limited overnight camping. Please contact Ed Molloy to reserve your spot. (780-922-5218).

Hotels accepting dogs:

Days Inn, 201 Palisades Way, Sherwood Park, AB (780) 570-8080

All rooms have kitchenettes, waiving pet fees, includes breakfast and giving special rates for ALCA participants

Check for more hotels in area: www.OfficialPetHotels.com

Camping:

Lindbrook Stargazer, <http://www.lindbrookstargazer.ca> (780) 662-4439

Half Moon Lake Resort (780) 922-3045

Elk Island National Park (780) 992-2950



COURSE LAYOUT

Courses subject to change depending on weather and safety considerations

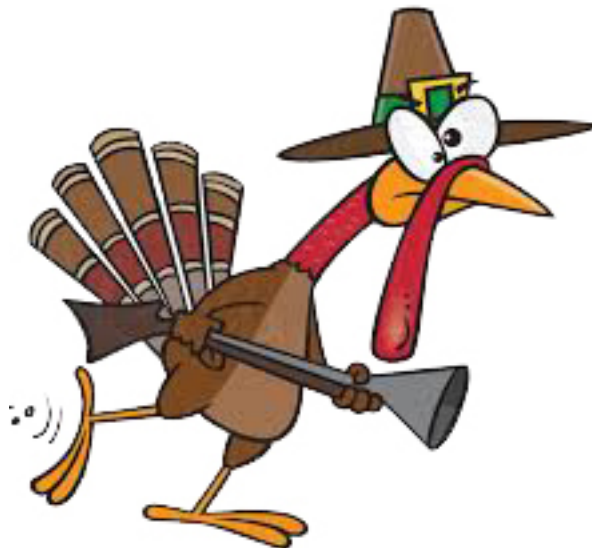
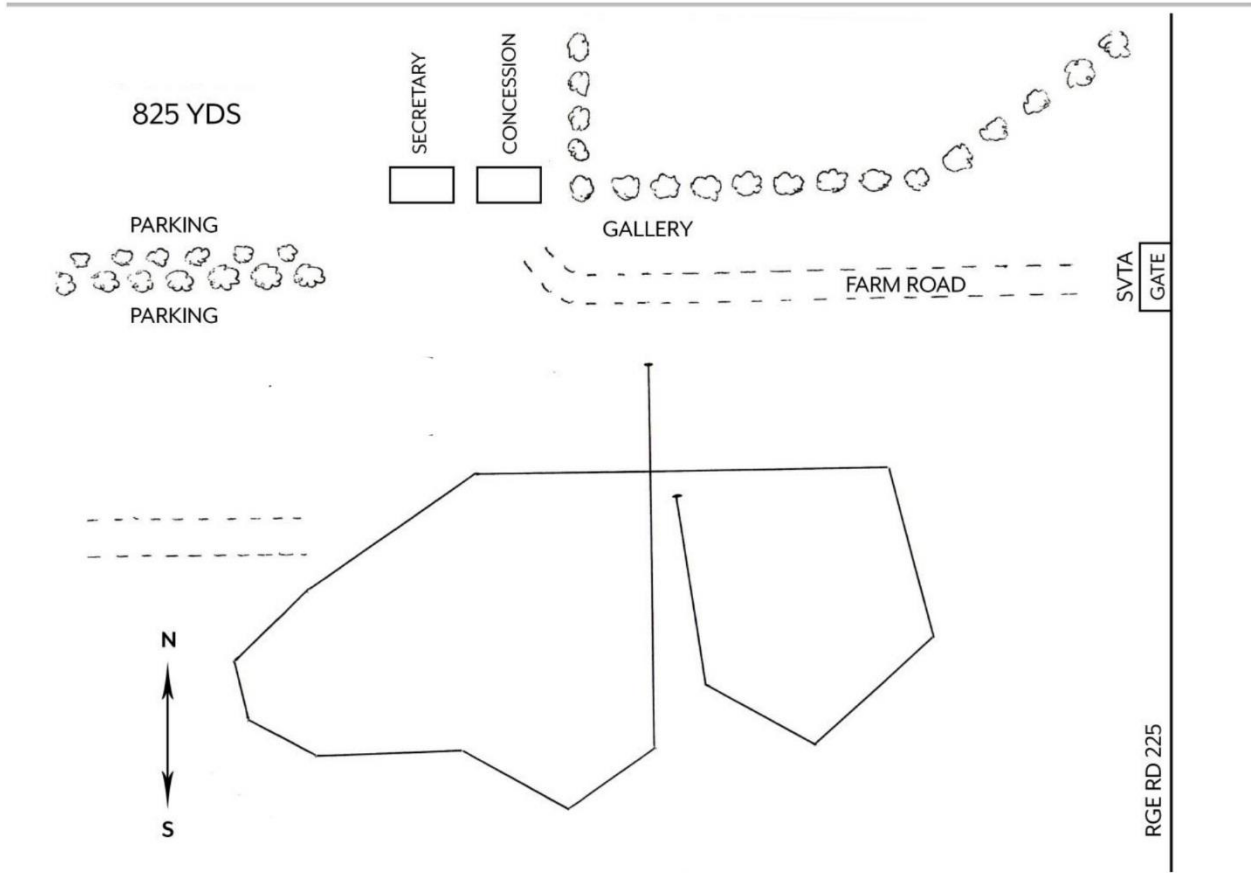

**ALL RULES GOVERNING THESE EVENTS
ARE AVAILABLE ON LINE FROM THE CANADIAN KENNEL CLUB**
<https://www.ckc.ca/en/Files/Forms/Shows-Trials/Event-Rules-Regulations/Lure-Coursing-Field-Trial-Rules-and-Regulations.aspx>

**FOR YOUR CONVENIENCE RULES PERTAINING TO SOME
FAQ'S ARE PRINTED BELOW**

7.1 Eligibility of Hounds

7.1.1 To be eligible to compete at approved lure coursing field trials a dog must meet the following requirements:

- (a) A hound must be tested with another dog, of the same breed or a breed with a similar running style (preferably not a kennelmate) and certified running clean by a licensed judge. Hounds must be a minimum of 11 months old prior to being certified, and must run a course of at least 600 yards (548.4 m) in order to be certified.
- (b) A certificate signed by the judge is given to the owner at the time of the test and must be submitted to the Field Trial Secretary at the dog's first trial.
- (c) All dogs must be one year of age on the date of the trial to enter a regular stake and must be registered or eligible for registration in the records of the CKC as hereinafter provided.

1.1 Definitions

"**hound**" means when used in these rules: Afghan Hounds, Basenjis, Borzois, Deerhounds (Scottish), Greyhounds, Ibizan Hounds, Irish Wolfhounds, Italian Greyhounds, Pharaoh Hounds, Salukis and Whippets.

ATTENTION CANADIAN EXHIBITORS – INFO REGARDING TITLES

The following is quoted from the CKC website:

"The following non-member participation fee now applies and is retroactive to January 1, 2011.

The non-member participation fee applies to all Canadian residents who participate in a CKC event but are not CKC members and a participating non-member can choose to purchase a CKC membership or pay the non-member fee. This only applies to dogs wholly owned by non-members and is not applicable to CKC members or dogs co-owned with a CKC member. In order for the CKC to efficiently manage recording and tracking points, it's important that non-members select one of the two options within 30 days of notification or, unfortunately, we will be forced to cancel any awards and titles

Non-Member Participation Fee

24-12-3. Non-member participation fee

- a) An annual non-member participation fee for awards and titles will be charged to a Canadian non-member of CKC. The fee will match the ERN fee.*
- b) In order to protect the awards/titles earned, the non-member will have a choice either to become a CKC member or to pay the non-member participation fee. Failure to comply within 30 days of notification will cause all awards and titles to be canceled.*
- c) The Premium List must carry a note stating that "these fees apply only to dogs wholly owned by non-CKC members and are not applicable to CKC members."*

EVENT REGISTRATION NUMBERS (ERN)

All dogs that are foreign born and foreign owned and enter Canada for the sole purpose of entering CKC events do not require a CKC registration number but will require an Event Registration Number (ERN).

To obtain an ERN simply mail a copy of the dog's registration certificate with a cheque money order or VISA/Mastercard number (expiry date, cardholder's name and signature) in the amount of \$59.40 + GST payable to the Canadian Kennel Club. This Event Registration Number MUST be applied for with 30 days of the first day of entering a CKC Event. Please forward your request to The Canadian Kennel Club, Shows and Trials Division 100-89 Skyway Avenue, Etobicoke, Ontario M9W 6R4, Fax: (416) 675-6506.

Chapter 9.5 Placements and Awards

9.5.1 Hounds which are not to be scored are not to be added to a course.

9.5.2 Championship points in regular stakes shall be awarded on the basis of the following:

First Place: Four times the number of hounds competing in the stake with a maximum of 40 points.

Second Place: Three times the number of hounds competing in the stake with a maximum of 30 points.

Third Place: Twice the number of hounds competing in the stake with a maximum of 20 points.

Fourth Place: Points equal to the number of hounds competing in the stake to a maximum of 10 points.

Next Best Qualified Dog (NBQ): No points awarded.

Qualifying Score (QS): No points awarded.

9.5.3 A hound shall not receive a placement or be awarded points if it does not score at least 50 per cent of the total possible combined scores. Hounds which do not receive placements under this provision will, nevertheless, be considered as having been in competition for the purpose of awarding points. If a hound is excused in the preliminary run, that hound will not count as having been in competition when computing championship points. Hounds that are dismissed or declared ineligible shall count as having been in competition when computing championship points.



Official Canadian Kennel Club Entry Form

Alberta Lure Coursing Association
October 8, 2016
Sat _____

I Enclose \$ _____ for Entry Fees \$ _____ Listing Fees \$ _____ Other \$ _____
PLEASE TYPE OR PRINT CLEARLY

Breed _____ Call Name _____ Sex _____

Regular Classes	Unofficial Classes
Open _____	Puppy 6-9 mos _____ Veteran _____ Puppy 9-12 mos _____ Single _____ Puppy 12-18 mos _____ Breeder _____ Kennel _____ Club _____

Registered Name of Dog _____

Check one & enter Number here: Is this dog's first trial? Y___ N___
If Yes, bring or attach Certification

<input type="checkbox"/> CKC Reg. No. <input type="checkbox"/> CKC ERN No. <input type="checkbox"/> CKC Misc. Cert. No. <input type="checkbox"/> CKC PEN No. <input type="checkbox"/> Listed <input type="checkbox"/> Foreign No. & Country	Date of birth D_____ M_____ Y_____	Is this a puppy? Y___ N___
	Place of Birth: Canada _____ Elsewhere _____	Owner's CKC Membership No.

Breeder(s) _____

Sire _____

Dam _____

Reg'd Owner(s) _____

Owner's Address _____

City _____ Prov _____ Postal Code _____

Name of Owner's Agent (if any) at the Trial _____

Agent's Address _____

City _____ Prov _____ Postal Code _____

IDs will not be mailed – please supply email address below for entry confirmation

____ VISA ____ MASTERCARD ____ AMERICAN EXPRESS

CARD NO. _____ EXPIRY _____/_____

CARDHOLDER NAME (PLEASE PRINT): _____

I CERTIFY that I am the registered owner(s) of the dog or that I am the authorized agent of the owner(s) whose name(s) I have entered above and accept full responsibility for all statements made in this entry. I CERTIFY that one of the owners has the CKC membership number listed above. In consideration of the acceptance of this entry, I (we) agree to be bound by the rules and regulations of the Canadian Kennel Club and by any additional rules and regulations appearing in the premium list.

Signature of Owner or Agent _____ Telephone No. _____

E-MAIL: _____



Official Canadian Kennel Club Entry Form

Alberta Lure Coursing Association
October 8, 2016
Sat _____

I Enclose \$ _____ for Entry Fees \$ _____ Listing Fees \$ _____ Other \$ _____
PLEASE TYPE OR PRINT CLEARLY

Breed _____ Call Name _____ Sex _____

Regular Classes	Unofficial Classes
Open _____	Puppy 6-9 mos _____ Veteran _____ Puppy 9-12 mos _____ Single _____ Puppy 12-18 mos _____ Breeder _____ Kennel _____ Club _____

Registered Name of Dog _____

Check one & enter Number here: Is this dog's first trial? Y___ N___
If Yes, bring or attach Certification

<input type="checkbox"/> CKC Reg. No. <input type="checkbox"/> CKC ERN No. <input type="checkbox"/> CKC Misc. Cert. No. <input type="checkbox"/> CKC PEN No. <input type="checkbox"/> Listed <input type="checkbox"/> Foreign No. & Country	Date of birth D_____ M_____ Y_____	Is this a puppy? Y___ N___
	Place of Birth: Canada _____ Elsewhere _____	Owner's CKC Membership No.

Breeder(s) _____

Sire _____

Dam _____

Reg'd Owner(s) _____

Owner's Address _____

City _____ Prov _____ Postal Code _____

Name of Owner's Agent (if any) at the Trial _____

Agent's Address _____

City _____ Prov _____ Postal Code _____

IDs will not be mailed – please supply email address below for entry confirmation

____ VISA ____ MASTERCARD ____ AMERICAN EXPRESS

CARD NO. _____ EXPIRY _____/_____

CARDHOLDER NAME (PLEASE PRINT): _____

I CERTIFY that I am the registered owner(s) of the dog or that I am the authorized agent of the owner(s) whose name(s) I have entered above and accept full responsibility for all statements made in this entry. I CERTIFY that one of the owners has the CKC membership number listed above. In consideration of the acceptance of this entry, I (we) agree to be bound by the rules and regulations of the Canadian Kennel Club and by any additional rules and regulations appearing in the premium list.

Signature of Owner or Agent _____ Telephone No. _____

E-MAIL: _____

ALCA Waiver

Please include this signed document with your entry form.

WAVIERS CAN BE SIGNED BEFORE ROLL-CALL

I (we) agree that the Club holding this event has the right to refuse this entry for cause which the organizing committee shall deem to be sufficient.

In consideration of the acceptance of this entry, the holding of this event and the opportunity to have the dog judged, I (we) agree to hold the organizing committee, the organization which it represents, including its members, officers and directors, owners of the premises upon which the event is held and their employees, harmless from any claim for loss or injury which may be alleged to have been caused directly or indirectly to any person or thing by the act of this dog while in or upon the event premises, or grounds, or near any entrance thereto, and I (we) personally assume all responsibility and liability for any such claim.

I (we) further agree to hold the aforementioned parties harmless from any claim for loss of this dog by disappearance, theft, death, or otherwise, and from any claim for damage or injury, to be caused or alleged to be caused by negligence of the parties aforementioned, or by the negligence of any other person, or any other cause or causes.

I (we) hereby assume the sole responsibility for and agree to indemnify the aforementioned parties harmless from any and all loss and expenses (including legal fees) by reason of the liability imposed by law upon any of the aforementioned parties for damage because of bodily injuries, including death at any time resulting there from sustained by any person or persons, including myself (ourselves) or on account of damage to property, arising out of or in consequence of my (our) participation in this event, howsoever such injuries, death or damage to property may be caused or may have alleged to have been caused by negligence of the aforementioned parties or any of their employees or agents, or any other person.

Signature of Owner, Agent, Handler:

_____ **Date:** _____

Signature of parent/guardian is required for children under 18 years

